

# OCEAN CITY "TOPSAIL" REEL NO. 925

(Model A)

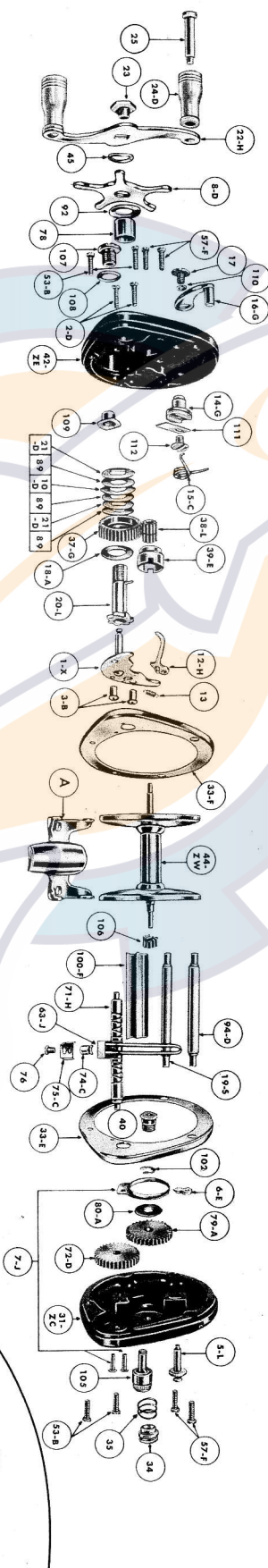

**HOW TO ORDER PARTS FOR YOUR REEL**—Locate the part desired in the illustration above and note part number. When ordering, state quantity, part number, part name and model letter which you will find on underside of reel stand. Enclose money order, stamps or check. Our minimum charge for one order is \$2.25; please add \$.15 on each order for return postage and insurance.

PART No.	PART NAME	PRICE	PART No.	PART NAME	PRICE	PART No.	PART NAME	PRICE
1-X	Bridge	.30	20-L	Gear Sleeve and Lock Pin	.60	40	Left Side Bearing	.20
2-D	Bridge Screw	.02	21-D	Drag Lock Washer	.05	42-L	Right Side Plate	1.25
3-B	Bridge Screw Nut	.04	22-H	Handle Complete with Part Nos. 24-D and 25	.80	43-R	Stand, For Salt Water Rod Reel Seat	.60
5-L	Click Button	.14	23	Handle Knob	.16	43-L	Stand, For Fresh Water Rod Reel Seat	.60
6-E	Click Pawl	.08	24-D	Handle Screw	.14	44-ZW	Spool	1.00
7-J	Click Spring and Rivets	.12	25	Handle Knob Rivet	.06	45	Star Top Washer	.04
8-D	Drag Star	.32	31-L	Left Side Plate Complete with Part Nos. 5-L, 6-E and 7-J	1.25	53-B	Right and Left Side Stand Screw	.02
10-D	Drag Eared Washer	.05	33-E	Left Side Plate Ring	.40	57-F	Line Guide	.40
12-H	Drag Dog	.03	33-F	Right Side Plate Ring	.40	63-J	Worm	.40
13	Drag Dog Spring	.50	34	Left Side Oil Cap	.12	71-H	Worm Gear	.24
14-G	Eccentric	.12	35	Left Side Oil Cap Spring	.04	72-D	Worm Pawl	.10
15-C	Eccentric Spring	.24	37-G	Main Gear	.75	74-C	Worm Pawl Cover	.02
16-G	Free Spool Lever	.05	38-L	Pinion Gear	.30	76	Worm Pawl Cover Screw	.02
17	Free Spool Lever Screw	.01	39-E	Pinion Gear Clutch	.30	78	Gear Sleeve Bushing	.08
18-A	Drag Fiber Washer	.12						
19-S	Frame Post							

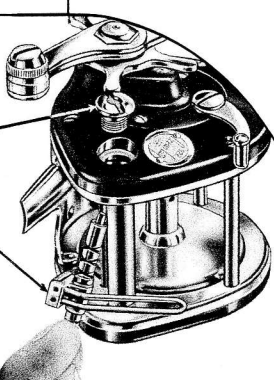

## WORM ADJUSTMENT BEARING

### QUICK CHANGE LEVEL WIND FEATURE

It's easy to replace the level wind parts on your TOPSAIL reel, or remove the level wind feature if you wish to do so.

With a coin, remove the WORM ADJUSTMENT BEARING of the Worm Guide Pawl. Pawl Cover and Pawl Cover Screw can then be lifted out of position as shown.

When replacing, install LEVEL WIND ASSEMBLY (shown) in left side of reel, and screw in with coin to remove and play in worm bearing. DO NOT SCREW IN WORM BEARING WITH COIN. ALWAYS BE SURE TO KEEP LEVEL WIND ASSEMBLY CLEAN AND WELL LUBRICATED WITH OIL.

When parts show signs of wear replace with new parts.